

# Jeremiah Lighting

# 28253-ABZG

*Please read carefully and save these instructions, as you may need them at a later date.*

## CAUTION

Turn off the main power at the circuit breaker before installing the fixture in order to prevent possible shock.

All electrical connections must be in accordance with local and National Electrical Code (N.E.C.) standards. If you are unfamiliar with proper electrical wiring connections, obtain the services of a qualified electrician.

## GENERAL

Remove all parts and hardware from the box and mounting package and make sure that none are missing by referencing the illustrations provided.

## ASSEMBLY AND INSTALLATION

1. Pull the SUPPLY WIRES (8 & 10) and the SUPPLY GROUND WIRE (7) out from the OUTLET BOX (1) (not included) and attach the MOUNTING STRAP (2) assembly to the OUTLET BOX (1) using the slotted holes of the MOUNTING STRAP (2) and the OUTLET BOX SCREWS and WASHERS (3). [See Fig. 1]
2. Remove the THREADED RING (16) from the SCREW COLLAR LOOP (5) and set aside. Place the CANOPY (15) over the OUTLET BOX (1) and adjust the SCREW COLLAR LOOP (5) and THREADED ROD (14) until the midpoint of the outside threads on the SCREW COLLAR LOOP (5) is centered (aligned) with the surface of the CANOPY (15). Remove the CANOPY (15) and tighten both HEX NUTS (4) down on the MOUNTING STRAP (2) and the SCREW COLLAR LOOP (5). [See Fig. 1]
3. Pull the ARMS (20) on the FIXTURE (21) so they are evenly spaced. [See Fig. 2]
4. Attach one OPEN CHAIN LINK (18) to each end of the CHAIN (17). Then attach one end of the CHAIN (17) to the FIXTURE LOOP (19). Slide the THREADED RING (16) and the CANOPY (15) (in that order) onto the CHAIN (17) and attach the other end of the CHAIN (17) to the SCREW COLLAR LOOP (5). Close the OPEN CHAIN LINKS (18). [See Fig. 1 & 2]

5. Unravel the FIXTURE LEAD WIRES (9 & 11) and FIXTURE GROUND WIRE (6) and thread them through every other link of the CHAIN (17) starting with the chain link attached to the FIXTURE LOOP (19). Feed the FIXTURE LEAD WIRES (9 & 11) and FIXTURE GROUND WIRE (6) through the SCREW COLLAR LOOP (5) and THREADED ROD (14). Pull the FIXTURE LEAD WIRES (9 & 11) and the FIXTURE GROUND WIRE (6) upward to remove any excess slack. [See Fig. 1]

6. Attach the power supply wires to the fixture lead wires by connecting the BLACK SUPPLY WIRE (8) to the SMOOTH FIXTURE LEAD WIRE (9) and the WHITE SUPPLY WIRE (10) to the RIBBED FIXTURE LEAD WIRE (11). Loop the SUPPLY GROUND WIRE (7) around the GROUND SCREW (13) on the MOUNTING STRAP (2). [Note: Be sure to provide an extra 3in. length of the SUPPLY GROUND WIRE (7) for connection to the FIXTURE GROUND WIRE (6).] Tighten the GROUND SCREW (13). Connect the remaining SUPPLY GROUND WIRE (7) to the FIXTURE GROUND WIRE (6). Use a WIRE CONNECTOR (12) for all wire connections. Push wiring and connections inside the OUTLET BOX (1). [See Fig. 1]

7. Slide the CANOPY (15) and the THREADED RING (16) up the CHAIN (17). Place the CANOPY (15) over the OUTLET BOX (1) and secure by screwing the THREADED RING (16) onto the SCREW COLLAR LOOP (5). [See Fig. 1]

## ASSEMBLY AND INSTALLATION (Continued)

8. Install bulbs, MAXIMUM 60W each.

9. Attach the THREADED ROD (22) to the bottom of the FIXTURE (21) and secure with the (uppermost) HEX NUT (22). Slide one of the STEEL WASHERS (25) over the THREADED ROD (22) and up against the HEX NUT (22) at the bottom. Next, slide one of the RUBBER WASHERS (26), the GLASS SHADE (24), the other RUBBER WASHER (26), and the other STEEL WASHER (25) over the THREADED ROD (22). Secure all parts with the HEX NUT (23). Attach the BOTTOM FONT (27); secure with the FINIAL (28). [See Fig. 2]

## INSTALLATION IS NOW COMPLETE

### JOSEPHINE

FIG. 1

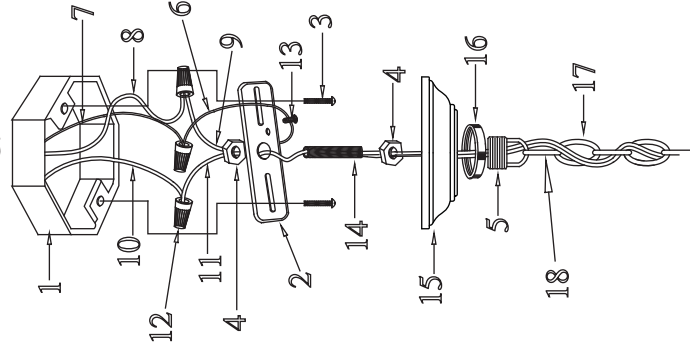
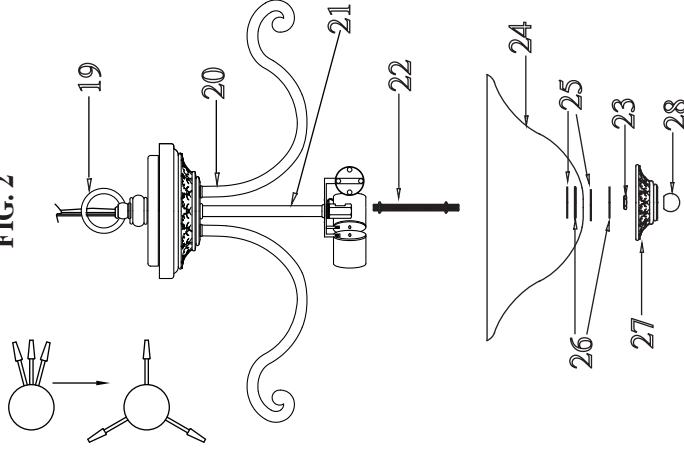

FIG. 2



### 3-LIGHT CONVERTIBLE (PENDANT)

- |   |                                  |                   |
|---|----------------------------------|-------------------|
| 1. OUTLET BOX (NOT INCLUDED)                                | 13. GROUND SCREW (pre-attached)  | 23. HEX NUT       |
| 2. MOUNTING STRAP   | 14. THREADED ROD (pre-attached)  | 24. GLASS SHADE   |
| 3. OUTLET BOX SCREW and WASHER (pre-attached to outlet box) | 15. CANOPY                       | 25. STEEL WASHER  |
| 4. HEX NUT  | 16. THREADED RING (pre-attached) | 26. RUBBER WASHER |
| 5. SCREW COLLAR LOOP (pre-attached)                         | 17. CHAIN                        | 27. BOTTOM FONT   |
| 6. FIXTURE GROUND WIRE (not included)                       | 18. OPEN CHAIN LINK              | 28. FINIAL        |
| 7. SUPPLY GROUND WIRE (not included)                        | 19. FIXTURE LOOP                 |                   |
| 8. BLACK SUPPLY WIRE (not included)                         | 20. ARM (pre-attached)           |                   |
| 9. SMOOTH FIXTURE LEAD WIRE                                 | 21. FIXTURE                      |                   |
| 10. WHITE SUPPLY WIRE (not included)                        | 22. THREADED ROD with HEX NUTS   |                   |
| 11. RIBBED FIXTURE LEAD WIRE                                |                                  |                   |
| 12. WIRE CONNECTOR  |                                  |                   |

# Jeremiah

## Lighting

# 28253-ABZG

*Please read carefully and save these instructions, as you may need them at a later date.*

### CAUTION

Turn off the main power at the circuit breaker before installing the fixture in order to prevent possible shock.

All electrical connections must be in accordance with local and National Electrical Code (N.E.C.) standards. If you are unfamiliar with proper electrical wiring connections, obtain the services of a qualified electrician.

### GENERAL

Remove all parts and hardware from the box and make sure that no parts are missing by referencing the illustrations provided.

### ASSEMBLY AND INSTALLATION

1. Locate the DECORATIVE NUTS (29) on the FIXTURE (21) and remove. Then, unravel the FIXTURE LEAD WIRES (9 & 11) and FIXTURE GROUND WIRE (6). Unscrew the FIXTURE LOOP (19) from the THREADED ROD (14) at the top of the FIXTURE (21) and then remove the FIXTURE LOOP (19), CUP (32), COVER (31), and MOUNTING STRAP (2) from the top of the FIXTURE (21). [See Fig. 1 & 2]
2. Pull the SUPPLY WIRES (8 & 10) and the SUPPLY GROUND WIRE (7) out from the OUTLET BOX (1) (not included) and attach the MOUNTING STRAP (2) to the OUTLET BOX (1) using the slotted holes of the MOUNTING STRAP (2) and the OUTLET BOX SCREWS and WASHERS (3). [See Fig. 1]
3. Place the top of the FIXTURE (21) over the OUTLET BOX (1) to determine the amount of adjustment necessary; the FIXTURE SCREWS (4) should come through holes in FIXTURE (21) just enough so that DECORATIVE NUTS (29) fit flush when FIXTURE (21) is mounted. Remove the FIXTURE (21) and tighten both 1/8in. IPS HEX NUTS (4) down on the MOUNTING PLATE (2). [See Fig. 1]
4. Pull the ARMS (20) on the FIXTURE (21) so they are evenly spaced. [See Fig. 2]
5. Attach the power supply wires to the fixture lead wires by connecting the BLACK SUPPLY WIRE (8) to the SMOOTH FIXTURE LEAD WIRE (9) and the WHITE SUPPLY WIRE (10) to the RIBBED FIXTURE LEAD WIRE (11). Loop the SUPPLY GROUND WIRE (7) around the GROUND SCREW (13) on the MOUNTING STRAP (2). [Note: Be sure to provide an extra 3in. length of the SUPPLY GROUND WIRE (7) for connection to the FIXTURE GROUND WIRE (6).] Tighten the GROUND SCREW (13). Connect the remaining SUPPLY GROUND WIRE (7) to the FIXTURE GROUND WIRE (6). Use a WIRE CONNECTOR (12) for all wire connections. Push wiring and connections inside the OUTLET BOX (1). [See Fig. 1]
6. Place FIXTURE (21) over the FIXTURE SCREWS (4) and secure with the DECORATIVE NUTS (29) provided. [See Fig. 1]
7. Install bulbs, MAXIMUM 60W each.
8. Attach the THREADED ROD (22) to the bottom of the FIXTURE (21) and secure with the (uppermost) HEX NUT (22). Slide one of the STEEL WASHERS (25) over the THREADED ROD (22) and up against the HEX NUT (22) at the bottom. Next, slide one of the RUBBER WASHERS (26), the GLASS SHADE (24), the other RUBBER WASHER (26), and the other STEEL WASHER (25) over the THREADED ROD (22). Secure all parts with the HEX NUT (23). Attach the BOTTOM FONT (27); secure with the FINIAL (28). [See Fig. 2]

**INSTALLATION IS NOW COMPLETE**

## JOSEPHINE

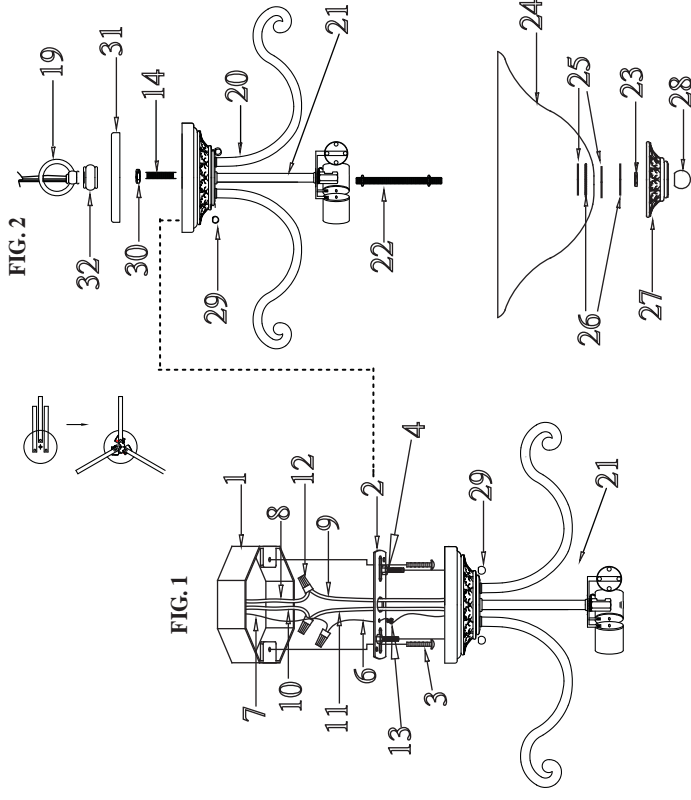

### 3-LIGHT CONVERTIBLE (SEMI-FLUSH)

1. OUTLET BOX (NOT INCLUDED)
2. MOUNTING STRAP
3. OUTLET BOX SCREW and WASHER (pre-attached to outlet box)
4. FIXTURE SCREWS and HEX NUTS (pre-installed)
6. FIXTURE GROUND WIRE
7. SUPPLY GROUND WIRE (not included)
8. BLACK SUPPLY WIRE (not included)
9. SMOOTH FIXTURE LEAD WIRE
10. WHITE SUPPLY WIRE (not included)
11. RIBBED FIXTURE LEAD WIRE
12. WIRE CONNECTOR
13. GROUND SCREW (pre-attached)
14. THREADED ROD (pre-attached)
19. FIXTURE LOOP
20. ARM (pre-attached)
21. FIXTURE
22. THREADED ROD and HEX NUTS
23. HEX NUT
24. GLASS SHADE
25. STEEL WASHER
26. RUBBER WASHER
27. BOTTOM FONT
28. FINIAL
29. DECORATIVE NUTS
30. HEX NUT
31. COVER
32. CUP